

HUB GEAR CABLE 3-SPEED P TYPE FOR UNDER-BAR SHIFTER

- OUTER LENGTH 1291mm (marked **HUB-3-P**)
- INNER LENGTH 1450mm
- Compatible with P Type bar & Brompton under-bar 3-speed shifter **ONLY**

REMOVING THE GEAR CABLE

- Select gear 3 on the shifter, backpedal to engage the hub
- Unscrew the indicator chain locknut (fig. 1)
- Unscrew the indicator chain from the gear cable anchor
- Undo the gear cable anchor clamp nut and release the inner gear cable
- If there is a cable crimp fitted to the cable end you will need to remove this, then pull the cable out of the clamp
- Pull the cable housing away from the shifter
- Remove the inner cable from the cable housing
- Select gear 1 and then press the shift lever downward so it does not obscure the cable entry hole
- Feed the gear cable through the shifter so that the cable nipple ejects from the cable entry hole
- If there is resistance pushing the cable through the bush pull the cable back a little and try again
- Keep feeding the cable through until the cable can be fully removed from the shifter

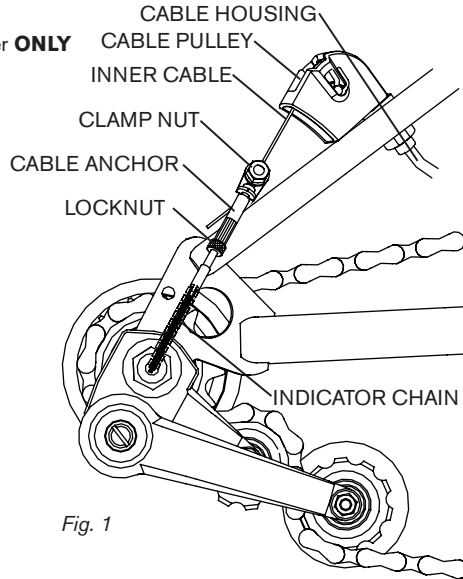

Fig. 1

FITTING A NEW CABLE

- Select gear 1 and then press the shift lever downward so it does not obscure the cable entry hole (fig. 2)
- Feed the gear cable into the shifter and through the cable bush
- If there is resistance pushing the cable through the bush pull the cable back a little and try again
- Once you can feel the cable pass through the bush keep feeding it until you feel slight resistance
- Keep feeding it through so that it follows around the guide inside the shifter and exits through the cable barrel

DO NOT FORCE THE CABLE AS THIS MAY DAMAGE THE SHIFTER

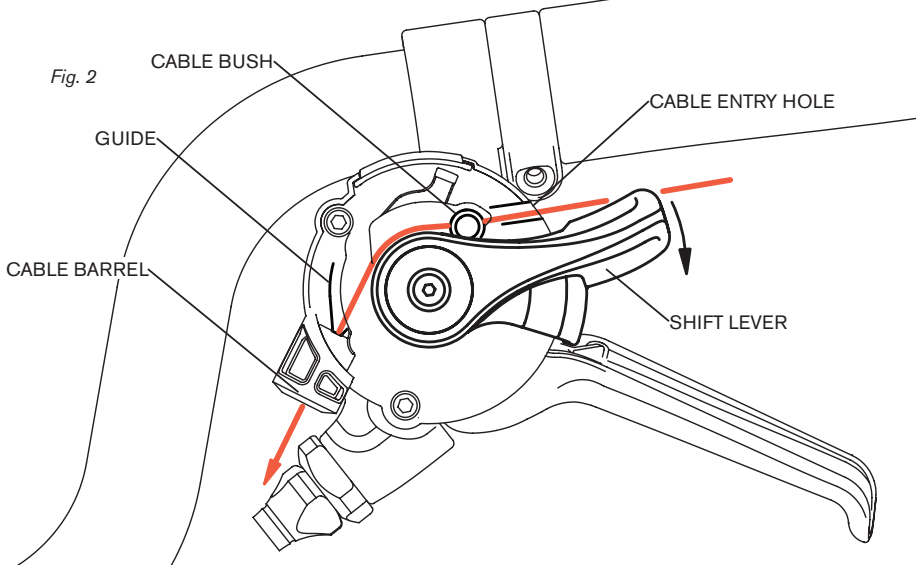

Fig. 2