

MODELL „ULTIMATE4“

- Ⓓ MONTAGEANLEITUNG:
- Ⓔ ASSEMBLY INSTRUCTIONS:
- Ⓕ INSTRUCTIONS DE MONTAGE:
- Ⓘ ISTRUZIONI DI MONTAGGIO:
- Ⓜ MONTAGE HANDLEIDING:
- Ⓚ MONTERINGSVEJLEDNING:
- LENKERTASCHE
- HANDLEBAR BAG
- SACOCHE POUR GUIDON
- BORSA DA MANUBRIO
- STUURTAS
- STYRTASKE

- Ⓔ INSTRUCCIONES DE MONTAJE:
- Ⓢ MONTERINGS ANVISNING:
- Ⓝ MONTERINGS ANVISNING:
- Ⓜ ASENNUSOHJEET:
- Ⓟ INSTRUKCJA MONTAŻU:
- Ⓝ 組立方法

- BOLSA PARA MANILLAR
- STYRSTÄNGS VÄSKA
- STYREVESKE
- TANKOLAUKKU
- TOREBKA NA KIEROWNICE
- ハンドルバーバッグ



ULTIMATE4 Plus	incl.	incl.	= + Art. # F 14 (Option)	= + Art. # F 94 (Option)	
L					
M					
ULTIMATE4 Classic	incl.	= + Art. # E 141 (Option)	= + Art. # F 14 (Option)	= + Art. # F 94 (Option)	
L					
M					
ULTIMATE4 Compact	incl.				

1.

22 - 31,8 mm
(Small to oversized) ✓ = O.K.

2.

Carbon

3.

Max. 2 ⌚
= #4

4.

Max. 3 ⌚
= #4

5.

6.

Pull

7.

100% = #4

8.

90° ✓ = O.K.

9.

100% = #4

10.

70 mm

11.

12.

13.

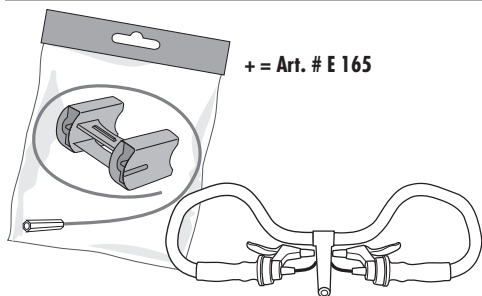

14.

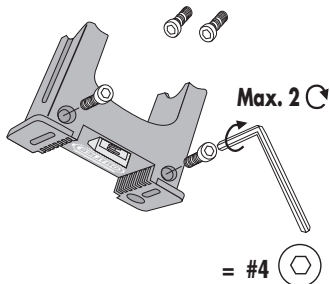

15.

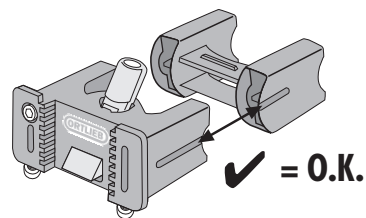

16.

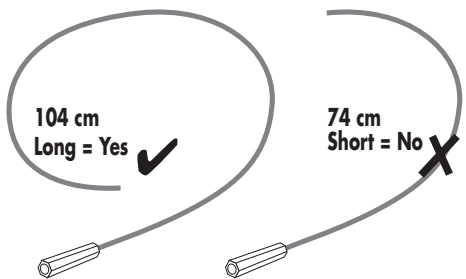

17.

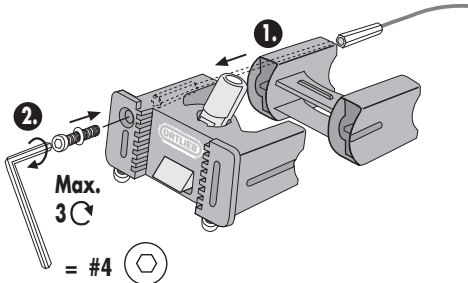

18.

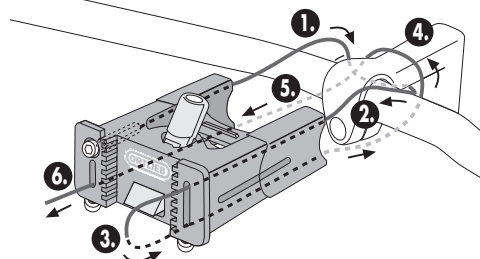

19.

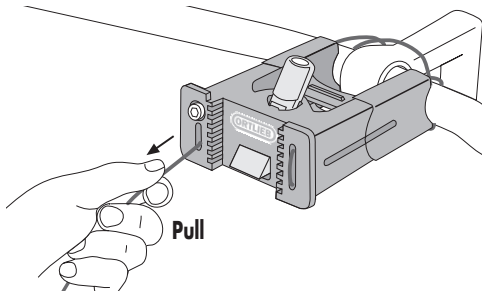

20.

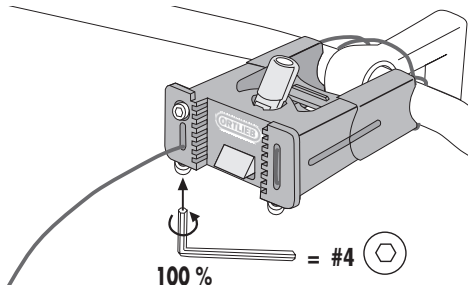

21.

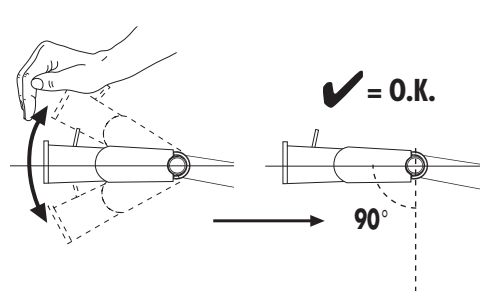

22.

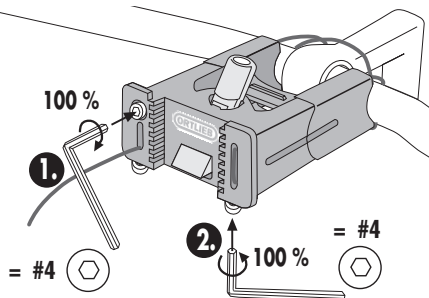

23.

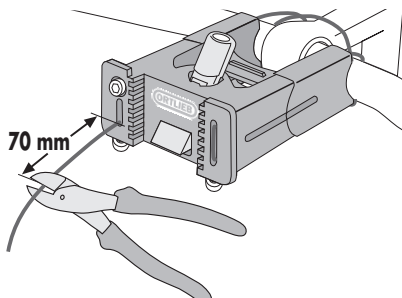

24.

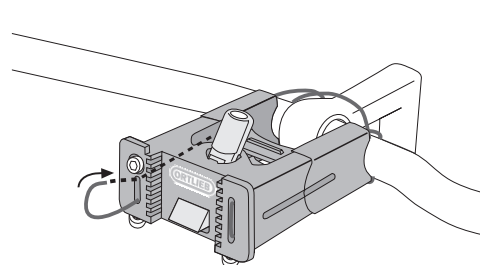

25.

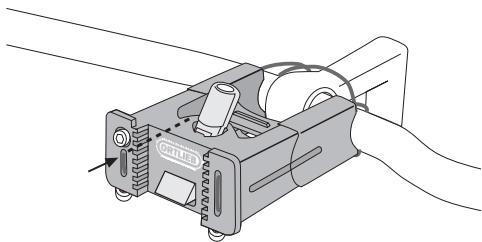

26.

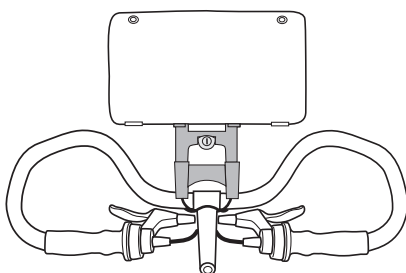

27.

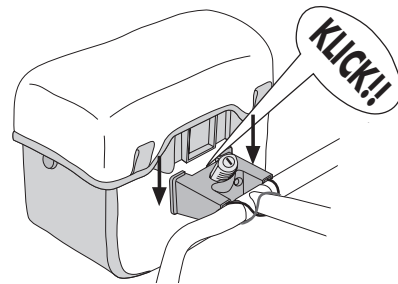

28.

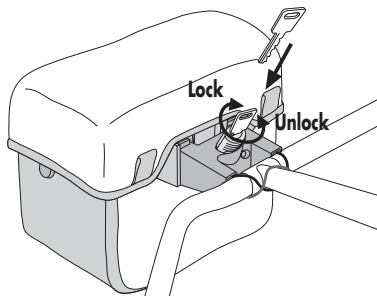

29.

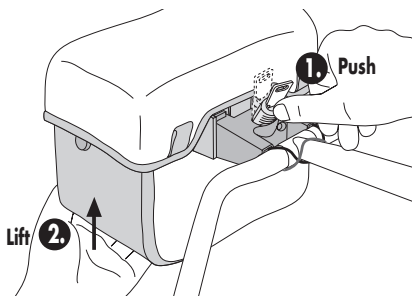

30.

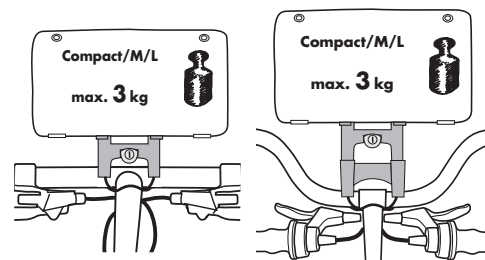

Accessories

+ = Art. # E 164

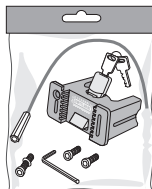

+ = Art. # E 165

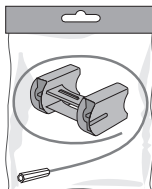

+ = Art. # E 167

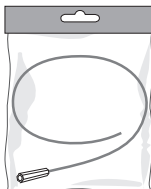

+ = Art. # E 141

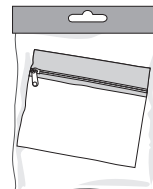

+ = Art. # F 14

