

FRONT CARRIER LATCH.

NOTE: With the new style of latch lever LL shown, **no** washer should be used with the screw ST.

Fitting instructions

You need a Posidriv screw-driver.

Remove the screw ST, and withdraw the old latch.

If the original latch is of the earlier (pre-2005) style, quite different in appearance from that shown, discard the M5 washer. The new style of latch, LL, is designed to be mounted without a washer (if a washer were used under the screw head, the screw head might prevent luggage items from fitting correctly on the block).

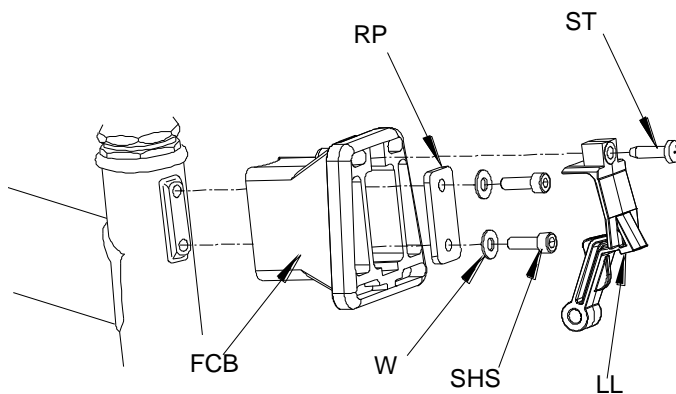

Feed the bottom end of the latch lever LL through the hole in the base of the carrier block FCB and then, holding the bottom of the latch lever, position the top of the latch lever in the carrier block. Feed the self tapping screw ST through the hole in the latch lever and secure into the carrier block.

This screw must be done up firmly: if the latch is not properly locked in place, it will be ineffective, and luggage may fall off, which is dangerous.

FRONT CARRIER LATCH.

NOTE: With the new style of latch lever LL shown, **no** washer should be used with the screw ST.

Fitting instructions

You need a Posidriv screw-driver.

Remove the screw ST, and withdraw the old latch.

If the original latch is of the earlier (pre-2005) style, quite different in appearance from that shown, discard the M5 washer. The new style of latch, LL, is designed to be mounted without a washer (if a washer were used under the screw head, the screw head might prevent luggage items from fitting correctly on the block).

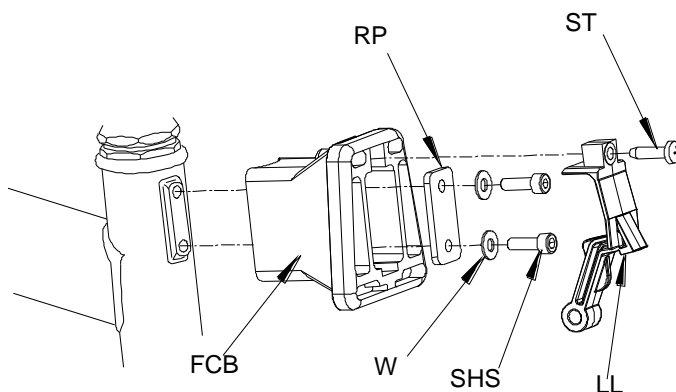

Feed the bottom end of the latch lever LL through the hole in the base of the carrier block FCB and then, holding the bottom of the latch lever, position the top of the latch lever in the carrier block. Feed the self tapping screw ST through the hole in the latch lever and secure into the carrier block.

This screw must be done up firmly: if the latch is not properly locked in place, it will be ineffective, and luggage may fall off, which is dangerous.